

**Warranty:** If this unit fails during the warranty period, contact tii customer service to authorize return. Unit may be returned prepaid.



141 Rodeo Drive  
Edgewood, NY 11717  
Toll Free 888.844.4720  
www.tiinettech.com

**Model 505F Series**  
Fiber Interface Device



## Installation Note

**CAUTION:** The Product shall be installed in a manner to comply with applicable national and local safety codes.

**ATTENTION :** Le produit doit être installé de manière à se conformer aux réglementations nationales et locales applicables en matière de sécurité.

## Description

1. The TII 505FT Series Fiber Optic Interface Device is a compact fiber patch & splice and fiber slack storage enclosure.
2. The large split grommets and cable clamps are located at the bottom of the base allow Telco drop lines and fiber cables to enter and exit the device.
3. The TII 505FT Series allows for sufficient drop/fiber cable slack storage.

## Features

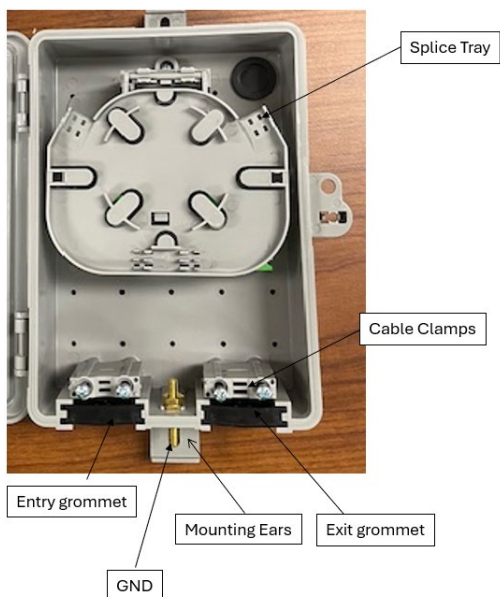

Figure 1

## Installation

1. Mount the 505FT Device so as to minimize the possibility of dirt or moisture getting into the enclosure.
2. 505FT Devices mounted side-by-side or end-to-end should be placed so covers can easily be opened.
3. Mount the 505FT using external mounting ears with appropriate hardware.
4. You are now ready to install the drop/fiber cable slack into the enclosure and prepare for wiring.

## Wiring

1. Punch a hole through the left grommet and guide the cable through the entry grommet. Make sure to use correct Cable clamps configuration as shown below in Figure 2.

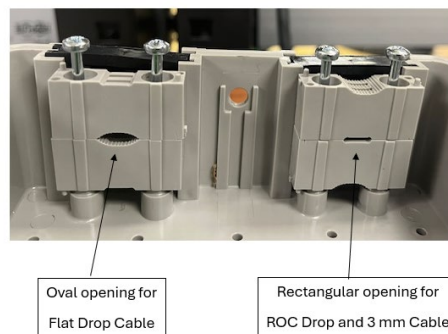

Figure 2

2. Connectorized cable can be installed by unscrewing and lifting the top part of the cable clamp. Tighten screws afterwards to secure the cable.



**Figure 3**

3. Wrap the excess drop cable/fiber cable slack in the clockwise direction and place it into the base enclosure. Figure 3
4. If splicing is required and unit is configured with hinged splice tray, splice drop cables on the top of the splice tray.
5. Wrap excess fiber cable around the splice tray. Figure 4



**Figure 4**

6. Plug connector into the SC adapter tower.
7. If splicing is required and unit is configured with the FP-01 splice tray, splice drop cables on the top of the splice tray.
8. Splice the feeder fiber to a fiber pigtail or directly to the customer fiber. If using a pigtail, insert fiber connector into the upper port of the SC adapter
9. Remove Splice Cover and insert splice sleeve into holder, manage excess pigtail around fiber plate and replace cover. Figure 5.

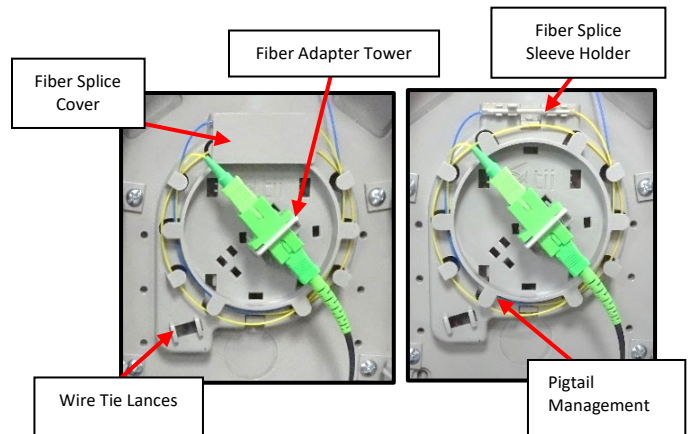

**Figure 5**

10. Punch a hole through the right grommet and guide the cable through the exit grommet and secure it using cable clamps.
11. Wrap the excess output cable slack in the clockwise direction and place it into the base enclosure.
12. Plug connector into the corresponding SC adapter. Figure 6

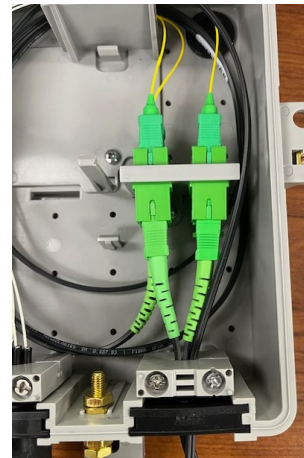

**Figure 6**

13. Close and secure the cover. Tighten the security hex screw until it is snug. Be sure not to over tighten the screw.