

**Warranty:** If this unit fails during the warranty period, contact tii customer service to authorize return. Unit may be returned prepaid.



141 Rodeo Drive  
Edgewood, NY 11717  
Toll Free 888.844.4720  
www.tiitech.com



**Model WM2PBF**  
WALL MOUNT PATCH & SPLICE FIBER ENCLOSURE

## Installation Note

### Description

Wall mount fiber distribution unit designed to support patching and splicing in one unit. The enclosure has 2 adapter panel positions, allowing for a wide variety of fiber termination connector types. Two compartments separate the network terminations from the distribution terminations and the unit has a single outer door with optional key lock.

### Features

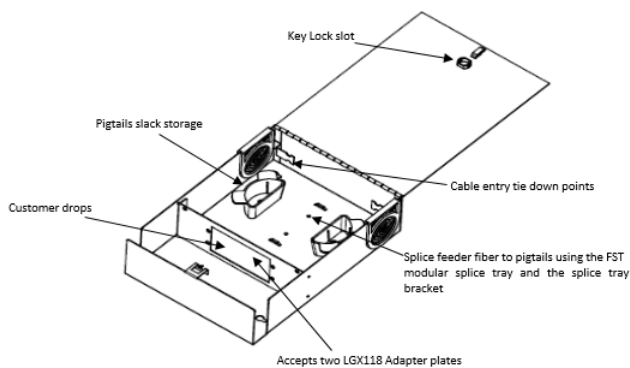

### Installation

The WM2PBF is designed for indoor installation. It can be ordered empty and configured on-site or factory loaded with adapter plates, pigtailed and splice trays to reduce the installation time.

1. Select a vertical indoor wall surface with easy access and adequate clearance from other fixtures and power circuits. Near a suitable earth ground.
2. Utilize a plywood backer board or fastener anchors as appropriate to the install surface.

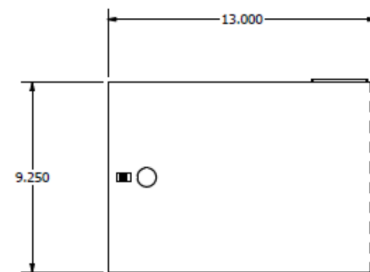
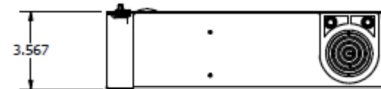

3. Mark and install appropriate wall hanging hardware and secure the unit.

